

vtech[®]
Baby

Parent's Guide

Twinkle & Soothe Owl Projector™



91-003346-000 ©

INTRODUCTION

Thank you for purchasing the **Twinkle & Soothe Owl Projector™** by **VTech®**! This adorable, sleepy-eyed owl projects a calming rotating image onto the ceiling to lull your little one to sleep. Choose between two sound modes to play sing-along songs, calming melodies or soothing noise. The delightful 3D nature scene inside the owl's tummy moves and is illuminated, bringing the scene to life.

**Light Control
Button**

**Volume
Buttons**

**Sensor
Switch**

**Play/Pause
Button**

**Volume
Buttons**

**Remote
Control**

**Music
Button**

**Rotatable
Receiver**

**Motor Control
Button**

**On/Off/Mode
Selector Switch**

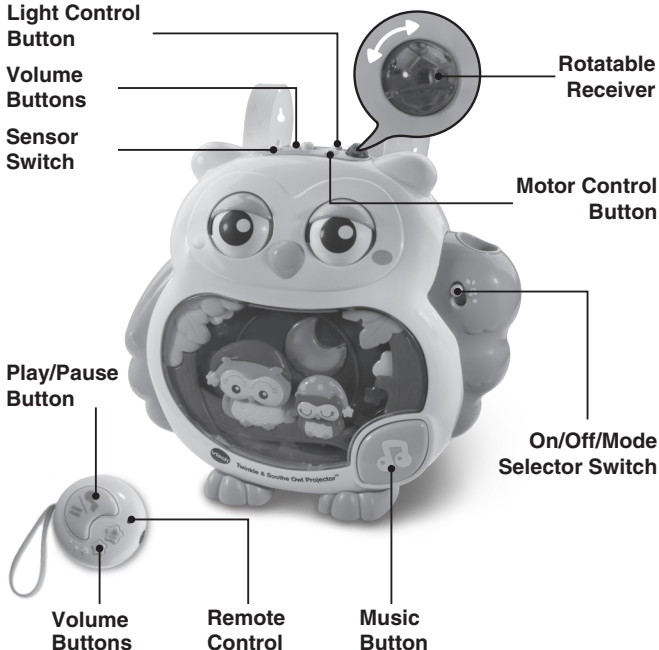

INCLUDED IN THIS PACKAGE

- One Twinkle & Soothe Owl Projector™
- One remote control
- Two adjustable crib straps
- One parent's guide

WARNING: All packing materials, such as tape, plastic sheets, packaging locks, removable tags, cable ties and packaging screws are not part of this toy, and should be discarded for your child's safety.

ATTENTION: Pour la sécurité de votre enfant, débarrassez-vous de tous les produits d'emballage tels que rubans adhésifs, feuilles de plastique, attaches, étiquettes et vis d'emballage. Ils ne font pas partie du jouet.

NOTE: Please keep this parent's guide as it contains important information.

Unlock the packaging locks:

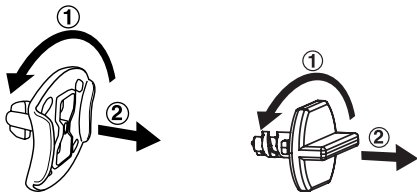

- ① Turn the packaging locks counterclockwise several times.
- ② Pull out and discard the packaging locks.

GETTING STARTED

BATTERY INSTALLATION

Owl Projector

1. Make sure the unit is turned **OFF**.
2. Locate the battery cover on the back of the unit. Use a screwdriver to loosen the screw.
3. Install 4 new AA (LR6/AM-3) batteries following the diagram inside the battery box. (The use of new alkaline batteries is recommended for maximum performance.)
4. Replace the battery cover and tighten the screw to secure.

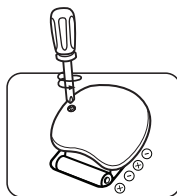

Remote Control

1. Locate the battery cover on the back of the **Remote Control**. Use a screwdriver to loosen the screw.
2. Install 2 new AAA (LR03/AM-4) batteries following the diagram inside the battery box.
3. Replace the battery cover and tighten the screw to secure.

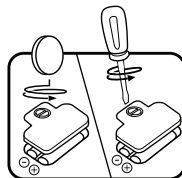

BATTERY NOTICE

- Use new alkaline batteries for maximum performance.
- Use only batteries of the same or equivalent type as recommended.
- Do not mix different types of batteries: alkaline, standard (carbon-zinc) or rechargeable, or new and used batteries.
- Do not use damaged batteries.
- Insert batteries with the correct polarity.
- Do not short-circuit the battery terminals.
- Remove exhausted batteries from the toy.
- Remove batteries during long periods of non-use.
- Do not dispose of batteries in fire.
- Do not charge non-rechargeable batteries.
- Remove rechargeable batteries from the toy before charging (if removable).
- Rechargeable batteries are only to be charged under adult supervision.

ASSEMBLY INSTRUCTIONS

With the **VTech® Twinkle & Soothe Owl Projector™**, safety comes first. To ensure your child's safety, adult assembly is required.

1. Slip one strap under a slot on the back of the unit. Then slip the other strap under the other slot.

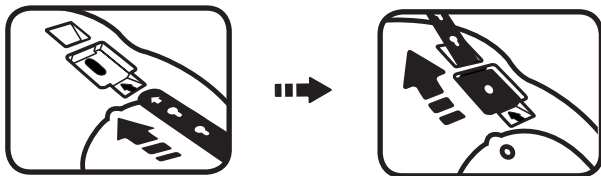

2. Place the unit against the bed rail bringing both straps over the top rail. Slip the top of the strap under the slot on the back of the unit and secure by choosing the appropriate hole. Repeat this procedure for the second strap.

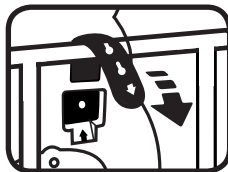

3. Fasten the cord on the back of the unit to the bed rail.

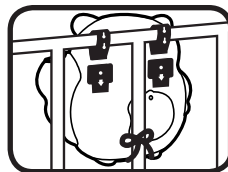

4. Pull slightly on the unit to make sure both straps have been securely fastened. The unit should be snug against the bed rail. Please check the unit frequently to ensure it is still secure.
5. The soother can also be placed on a night stand, dresser or table.

NOTE:

Please check the unit frequently to ensure it is still secure. We recommend removing the soother from the crib once your baby begins sitting or pushing up on all fours. At this time we suggest placing the soother on a night stand, dresser or table.

PRODUCT FEATURES

1. On/Off/Mode Selector Switch

To turn the unit on slide the **On/Off/Mode Selector Switch** to select either Lullaby Mode or Sound Mode. You will hear sing-along songs and soothing melodies in Lullaby Mode and soothing sounds in Sound Mode. If a light mode is selected, the projector will light up and the lights will twinkle to the music while the 3D image on the owl's tummy rotates.

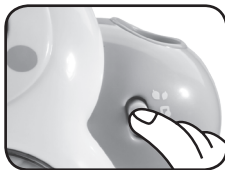

2. Timer Switch

Slide the **Timer Switch** to select the desired preset time. Once the timer has expired, the unit will enter sleep mode. Timer options include 10, 20 or 30 minutes.



3. Light Control Button

Press the **Light Control Button** to select one of four light modes.



4. Motor Control Button

Press the **Motor Control Button** to select one of three motor modes.



5. Music Button

In each mode, press the **Music Button** to play the next sound, melody or sing-along song depending on the selected mode.



6. Sound Sensor Switch

Slide the **Sound Sensor Switch** on or off. When the **Sound Sensor** is turned on, it will activate the **Twinkle & Soothe Owl Projector™** to play soothing sounds or music when your baby cries. The sound sensor will only wake up the unit when the **Sound Sensor Switch** is on. Once the selected time has expired, the unit will automatically power down.

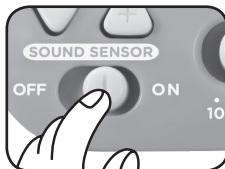

7. Volume Buttons

Press the **+ Button** to increase the volume or the **- Button** to decrease the volume.

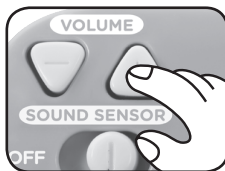

NOTE:

The unit's default volume level is level three when you first open the unit or when the batteries are changed. Once you have selected a volume level for your unit other than level one, the unit will remember that volume level each time you use the unit. If you have selected volume level one (silent mode) as your volume level, the unit will automatically default to volume level two once the unit has gone into sleep mode and is reactivated.

8. Remote Control

The **Remote Control** can start, pause and control the volume up to 30 feet away from the unit so not to disturb your baby. Be sure there are no obstructions directly between the **Remote Control** and the **Rotatable Receiver**. The **Remote Control** is disabled after 45 minutes without input.



NOTE:

Bright sunlight or artificial light may reduce the crib toy's sensitivity to the remote control. To increase the reliability, reduce ambient light near the crib toy.

9. Rotatable Receiver

The soother features a **Rotatable Receiver** which can be rotated to receive an optimal signal from the **Remote Control**.

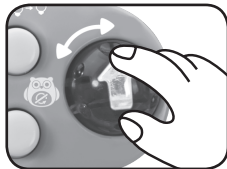

NOTE:

Rotatable Receiver can be rotated 180 degrees clockwise and 90 degrees counterclockwise from original setting.

10. Reactivating the Unit

The unit can be reactivated by pressing any button on the unit (not including the **Sound Sensor Switch**), by using the **Remote Control** (if used within 45 minutes of going into sleep mode) or when the sound sensor is activated by your baby's cry.

NOTE:

This product is in try-me mode in the packaging. After opening the package, turn the unit off and on again to proceed with normal play. If the unit repeatedly powers down quickly we suggest changing the batteries.

ACTIVITIES

1. Lullaby Mode

Select Lullaby Mode to listen to the sing-along songs and soothing melodies.

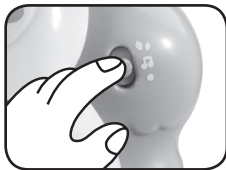

2. Sound Mode

Select Sound Mode to listen to a selection of soothing sounds.



3. Play & Pause Button on the Remote Control

Press the **Play & Pause Button** on the **Remote Control** to pause the sounds. Press it again to restart the sounds. If the unit is reactivated within 5 minutes the sing-along song, melody or soothing sounds will continue, but if the unit is paused for more than 5 minutes when reactivated, the next response will play.



4. Volume Buttons on the Remote Control

Press the **+ Button** to increase the volume or the **- Button** to decrease the volume.



NOTE:

Point the **Remote Control** directly at the front of the **Rotatable Receiver** and within 30 feet of the unit for an optimal signal.



MELODY LIST:

1. Au Clair de la Lune
2. Are you Sleeping?
3. Alouette
4. Adagio
5. All Through the Night
6. BINGO
7. Brahms' Lullaby
8. Blue Danube Waltz
9. Clementine
10. Concerto in C Major, 1st Movement
11. Canon in D
12. Cradle Song
13. Casse-Noisette Ouverture
14. Berceuse
15. Dance of the Sugar Plum Fairy
16. Did You Ever See a Lassie?
17. Clair de Lune
18. Greensleeves
19. Eine kleine Nachtmusik
20. Four Seasons - Spring, 1st movement
21. Four Seasons - Spring, 3rd movement
22. Four Seasons - Autumn, 1st movement
23. Four Seasons - Autumn, 3rd movement
24. Four Seasons - Winter, 2nd movement
25. Für Elise
26. Glow Worm
27. Hey Diddle Diddle
28. Roses are Red
29. Hush Little Baby
30. Happy Farmer
31. Little Robin Redbreast





32. Klipp-Klapp Galopp
33. Kinderscene Op.15
34. Listen to the Mockingbird
35. Little Bo Peep
36. Little Miss Muffet
37. Little Boy Blue
38. London Bridge
39. Piano Sonata in C, K. 545, 1st Movement
40. L'Empereur

SONG 1

(Tune of "Hush, Little Baby")

Hush, little baby, close your eyes.
Drift off to sleep in the soft glowing light.

SONG 2

(Tune of "Rock-a-Bye Baby")

Rock-a-bye baby, it's time to sleep.
Eyes shut tight 'til morning light.
Baby is sleepy, cozy and calm.
Now sleep tight little baby, I'll see you at dawn.

SONG 3

(Tune of "Lavender's Blue")

When nightfall comes dilly dilly,
I sing for you.
I'll sing so softly dilly dilly,
Rest your sweet head.



CARE & MAINTENANCE

1. Keep the unit clean by wiping it with a slightly damp cloth.
2. Keep the unit out of direct sunlight and away from any direct heat source.
3. Remove the batteries when the unit is not in use for an extended period of time.
4. Do not drop the unit on hard surfaces and do not expose the unit to moisture or water.

TROUBLESHOOTING

If for some reason the unit stops working or malfunctions, please follow these steps:

1. Please turn the unit **OFF**.
2. Interrupt the power supply by removing the batteries.
3. Let the unit stand for a few minutes, then replace the batteries.
4. Turn the unit **ON**. The unit should now be ready to play again.
5. If the product still does not work, replace with a new set of batteries.



If the problem persists, please call our Consumer Services Department at 1-800-521-2010 in the U.S. or 1-877-352-8697 in Canada, or by going to our website at vtechkids.com and filling out our Contact Us form located under the Customer Support link. A service representative will be happy to help you.



IMPORTANT NOTE:

Creating and developing **VTech**[®] products is accompanied by a responsibility that we at **VTech**[®] take very seriously. We make every effort to ensure the accuracy of the information, which forms the value of our products. However, errors sometimes can occur. It is important for you to know that we stand behind our products and encourage you to call our Consumer Services Department on at 1-800-521-2010 in the U.S. or 1-877-352-8697 in Canada, or by going to our website at vtechkids.com and filling out our Contact Us form located under the Customer Support link with any problem and/or suggestions that you might have. A service representative will be happy to help you.



Note:

This equipment has been tested and found to comply with the limits for a Class B digital device, pursuant to Part 15 of the FCC Rules. These limits are designed to provide reasonable protection against harmful interference in a residential installation. This equipment generates uses and can radiate radio frequency energy and, if not installed and used in accordance with the instructions, may cause harmful interference to radio communications. However, there is no guarantee that interference will not occur in a particular installation. If this equipment does cause harmful interference to radio or television reception, which can be determined by turning the equipment off and on, the user is encouraged

to try to correct the interference by one or more of the following measures:

- Reorient or relocate the receiving antenna.
 - Increase the separation between the equipment and receiver.
 - Connect the equipment into an outlet on a circuit different from that to which the receiver is connected.
 - Consult the dealer or an experienced radio/TV technician for help.
- 

THIS DEVICE COMPLIES WITH PART 15 OF THE FCC RULES. OPERATION IS SUBJECT TO THE FOLLOWING TWO CONDITIONS: (1) THIS DEVICE MAY NOT CAUSE HARMFUL INTERFERENCE, AND (2) THIS DEVICE MUST ACCEPT ANY INTERFERENCE RECEIVED, INCLUDING INTERFERENCE THAT MAY CAUSE UNDESIRE OPERATION.

CAN ICES-3 (B)/NMB-3(B)

Caution: Changes or modifications not expressly approved by the party responsible for compliance could void the user's authority to operate the equipment.





PRODUCT WARRANTY

This Warranty is applicable only to the original purchaser, is non-transferable and applies only to "VTech" products or parts. This product is covered by a 3-month Warranty from the original purchase date, under normal use and service, against defective workmanship and materials. This Warranty does not apply to (a) consumable parts, such as batteries; (b) cosmetic damage, including but not limited to scratches and dents; (c) damage caused by use with non-VTech products; (d) damage caused by accident, misuse, unreasonable use, immersion in water, neglect, abuse, battery leakage, or improper installation, improper service, or other external causes; (e) damage caused by operating the product outside the permitted or intended uses described by VTech in the owner's manual; (f) a product or part that has been modified (g) defects caused by normal wear and tear or otherwise due to the normal aging of the product; or (h) if any VTech serial number has been removed or defaced.

Prior to returning a product for any reason, please notify the VTech Consumer Services Department by going to our website at vtechkids.com, filling out our Contact Us form located under the Customer Support link or calling 1-800-521-2010.

If the service representative is unable to resolve the issue, you will be provided instructions on how to return the product and have it replaced under Warranty. Return of the product under Warranty must adhere to the following rules: If VTech believes that there may be a defect in the materials or workmanship of the product and can confirm the purchase date and location of the product, we will at our discretion replace the product with a new unit or product of comparable value. A replacement product or parts assumes the remaining Warranty of the original product or 30 days from the date of replacement, whichever provides longer coverage.

THIS WARRANTY AND THE REMEDIES SET FORTH ABOVE ARE EXCLUSIVE AND IN LIEU OF ALL OTHER WARRANTIES, REMEDIES AND CONDITIONS, WHETHER ORAL, WRITTEN, STATUTORY, EXPRESS OR IMPLIED. IF VTECH CANNOT LAWFULLY DISCLAIM STATUTORY OR IMPLIED WARRANTIES THEN TO THE EXTENT PERMITTED BY LAW, ALL SUCH WARRANTIES SHALL BE LIMITED TO THE DURATION OF THE EXPRESS WARRANTY AND TO THE REPLACEMENT SERVICE AS DETERMINED BY VTECH IN ITS SOLE DISCRETION.

To the extent permitted by law, VTech will not be responsible for direct, special, incidental or consequential damages resulting from any breach of Warranty.

This Warranty is not intended to persons or entities outside the United States of America. Any disputes resulting from this Warranty shall be subject to the final and conclusive determination of VTech.

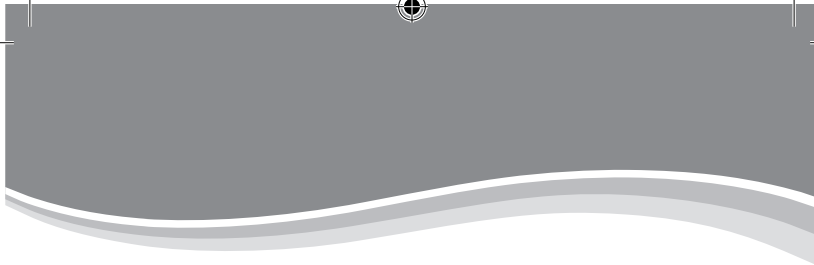

**Visit our website for more
information about our products,
downloads, resources and more.**

vtechkids.com



TM & © 2017 VTech Holdings Limited.
All rights reserved.
Printed in China.
91-003346-000 